

**B1** INSTALLATION DRAWING

IF THIS DOCUMENT IS PRINTED IN HARDCOPY, IT IS FOR INFORMATION USE ONLY AND THEREFORE IS NOT SUBJECT TO UPDATING CONTROLS. ALWAYS REFER TO SOLIDWORKS VIEWER FOR LATEST ISSUE



THIS DRAWING IS CONFIDENTIAL AND IS SUPPLIED ON THE EXPRESS CONDITION THAT IT SHALL NOT BE LOANED OR COPIED OR DISCLOSED TO ANY OTHER PERSON OR USED FOR ANY OTHER PURPOSE WITHOUT THE WRITTEN CONSENT OF AP RACING LTD.

**AP RACING**  
 Wheler Road  
 Coventry  
 CV3 4LB  
 Tel: +44 024 7663 9595  
 Fax: +44 024 7663 9559  
 e-mail: sales@apracings.co.uk  
 Web site: HTTP://www.apracings.com

Alterations				
Date & No.	Particulars	#	Zone	Initials
JAN '15 B7215	FIRST ISSUE			JT
13/09/16 B7623	MTG. HOLE DIA. CORRECTED FROM 12.3/12.2, NOW 12.27/12.17			CH
17/07/2017 B7726_01	ADDED TORQUE SPECIFICATIONS TO PAD RETAINING BOLTS			C10 SGW

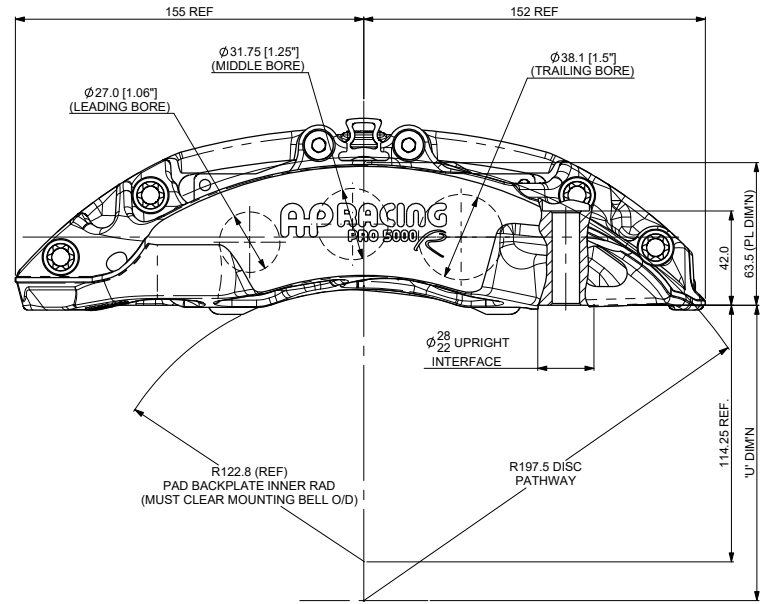
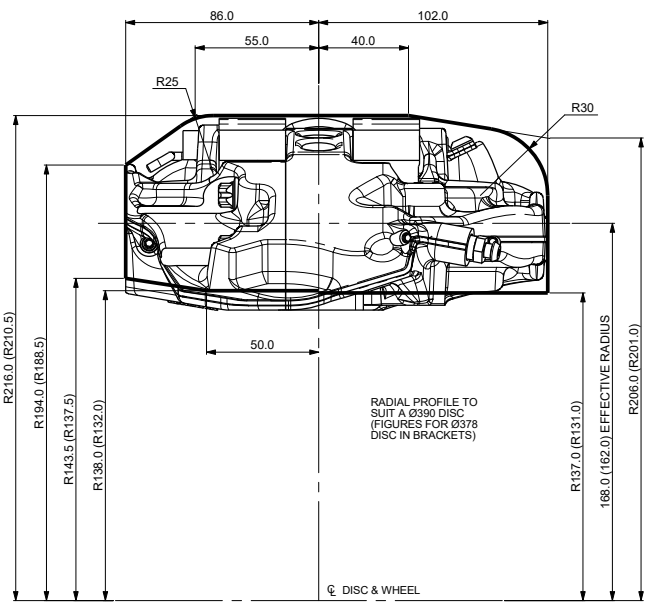

**GENERAL DESCRIPTION**  
 6 PISTON DIFFERENTIAL BORE CALIPER TO SUIT UP TO A Ø390mm x 35.56mm MAX / 32mm MIN THICK IRON DISC. PADS ARE RETAINED BY A BOLTED RETAINER, WITH A QUICK-RELEASE SPRING CLIP SUPPLIED FOR USE IN EVENTS WHEN FAST PAD CHANGES ARE REQUIRED.

**APPLICATION**  
 GENERAL USE CALIPER

**TECHNICAL INFORMATION**  
 TOTAL PISTON AREA: 50cm<sup>2</sup>  
 BODY MATERIAL: ALUMINIUM ALLOY  
 PISTON MATERIAL: STAINLESS STEEL

ASSEMBLY WEIGHT (LESS PADS, BOLTED PAD RETAINER): 3.1kg

**INSTALLATION INFORMATION**  
 DISC & CALIPER MOUNTING TOLERANCES TO BE SUCH THAT THE DISC IS CENTRAL TO THE CALIPER TO WITHIN ±0.5mm. DISC DIAMETRAL CLEARANCE SHOULD BE 2.5mm NOMINAL FROM DISC O/D TO PATHWAY.

**KEY TO DIMENSIONS**  
 'PL' DIMN : TOP OF PAD MATERIAL TO MOUNTING BOSS FACE.  
 'U' DIMN - WHEEL CENTRE LINE TO CALIPER MOUNTING BOSS FACE = (DISC Ø/2) - PL DIMN

**CALIPER PART NUMBERS**  
 CP9668-2S7L - RIGHT HAND  
 CP9668-3S7L - LEFT HAND

EXAMPLE PART # - CP9668-2 S (SIDE FEED) 7 (7lb AKB SPRINGS) L (STAINLESS PISTONS).

**PADS**  
 THE CORRECT PAD FAMILY FOR THIS CALIPER IS CP3558D54. PADS SHOULD BE ORDERED SEPERATELY.

**RECOMENDED DISC AND PAD OPTIONS AVAILABLE**  
 D54 DISC AND PAD COMBINATION

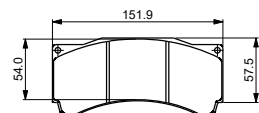

**CP3558D54 PAD FAMILY**  
 PAD AREA - 77.4cm<sup>2</sup>  
 VOLUME - 155.8cm<sup>3</sup>  
 THICKNESS - 25.0mm

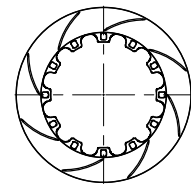

CP4284-134/5CG8 Ø390x36 12F 84v 8.7Kg  
 CP5772-1030/1CG8 Ø378x32 12F 72v 7.2Kg

**OPTIMUM BLEED POSITIONING**  
 FOR OPTIMUM BLEED, THE CALIPER SHOULD BE INSTALLED IN THE LEADING OR TRAILING POSITION, BETWEEN THE ANGLES SHOWN.

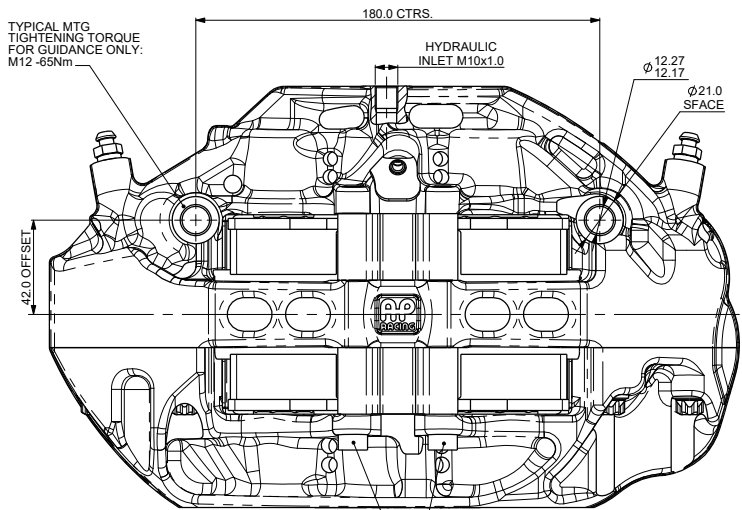
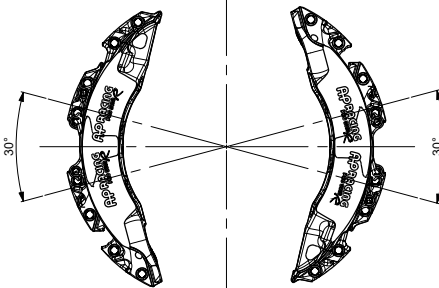

TYPICAL MTG TIGHTENING TORQUE FOR GUIDANCE ONLY: M12 -65Nm

PAD RETAINING BOLTS SHOULD BE TIGHTENED TO A TORQUE OF 27.1Nm (20lb ft)

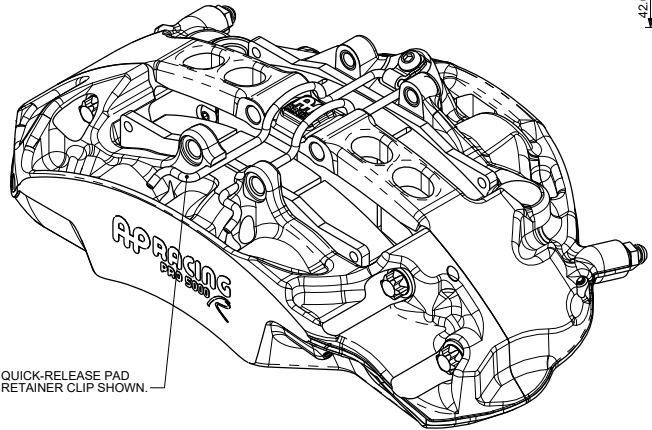

QUICK-RELEASE PAD RETAINER CLIP SHOWN.

SCALE 1:1	SHEET 1 OF 2
DRAWN Jon Tait	
APPROVED	
DERIVED FROM cp9665-1cd	
TITLE	
6 PISTON PRO 5000 R CALIPER 180x42 MOUNTING	
DRG NO. CP9668-1CD	

# B1 INSTALLATION DRAWING

IF THIS DOCUMENT IS PRINTED IN HARD COPY, IT IS FOR INFORMATION USE ONLY AND THEREFORE IS NOT SUBJECT TO UPDATING CONTROLS. ALWAYS REFER TO SOLIDWORKS VIEWER FOR LATEST ISSUE

FIRST ANGLE PROJECTION

THIS DRAWING IS CONFIDENTIAL AND IS SUPPLIED ON THE EXPRESS CONDITION THAT IT SHALL NOT BE LOANED OR COPIED OR DISCLOSED TO ANY OTHER PERSON OR USED FOR ANY OTHER PURPOSE WITHOUT THE WRITTEN CONSENT OF AP RACING LTD.

**AP RACING**  
 AP Racing  
 Wheler Road  
 Coventry  
 CV3 4LB  
 Tel: +44 024 7663 9595  
 Fax: +44 024 7663 9559  
 e-mail: sales@apracings.co.uk  
 Web site: HTTP://www.apracings.com

PAD RETAINER KIT - CP9665-12			
REF.	DESCRIPTION	PART NO.	QTY
8a	PAD RETAINER	CP9665-119	2
8b	M8 CAP SCREW	CP3715-117ST	2

QUICK RELEASE RETAINER KIT - CP9665-13			
REF.	DESCRIPTION	PART NO.	QTY
9a	PAD RETAINER CLIP	CP9665-118	1
9b	RETAINER HINGE	CP6268-110	1
9c	SCREW M6x12	CP3160-106ST	1

CP9665-2/ 3S/L SPARES				
REF	DESCRIPTION	PART NO.	QTY / ASSY	FITTING INSTRUCTIONS
1	Ø1.06 SST PISTON 33.1 LONG	CP9665-114	2	
2	Ø1.25 SST PISTON 33.1 LONG	CP9665-115	2	
3	Ø1.5 SST PISTON 33.1 LONG	CP9665-116	2	
4	SEAL KIT (6 SEALS)	CP8518-CEJ	1	REFER TO PUBLICATION REF: P14.290 & P14.220
5	BLEED SCREW KIT	CP3880-1	1	TIGHTENING TORQUE - 17Nm
6	M5 BUTTON SCREW	CP9440-116ST	4	APPLY A 1-2MM DROP OF LOCTITE 270 TO THE 2ND FROM LAST THREAD WHEN FITTING. TIGHTENING TORQUE - 3.7Nm
7	PAD WEAR PLATE	CP9668-106 RH CP9668-107 LH	2 2	APPLY 736 RTV SILICONE SPARINGLY BEHIND THE ABUTMENT PLATE ENSURING ENTIRE CONTACT FACE IS COVERED APPLY PRESSURE TO ABUTMENT PLATE WHEN FITTING TO ENSURE MINIMUM FILM THICKNESS AND AVOID ANY GAP ENSURE ABUTMENT PLATE SITS CORRECTLY AGAINST CALIPER BODY BEFORE FITTING RETAINING SCREWS
10	7Lb AKB SPRING KIT	CP6518-7LBSSL	1	

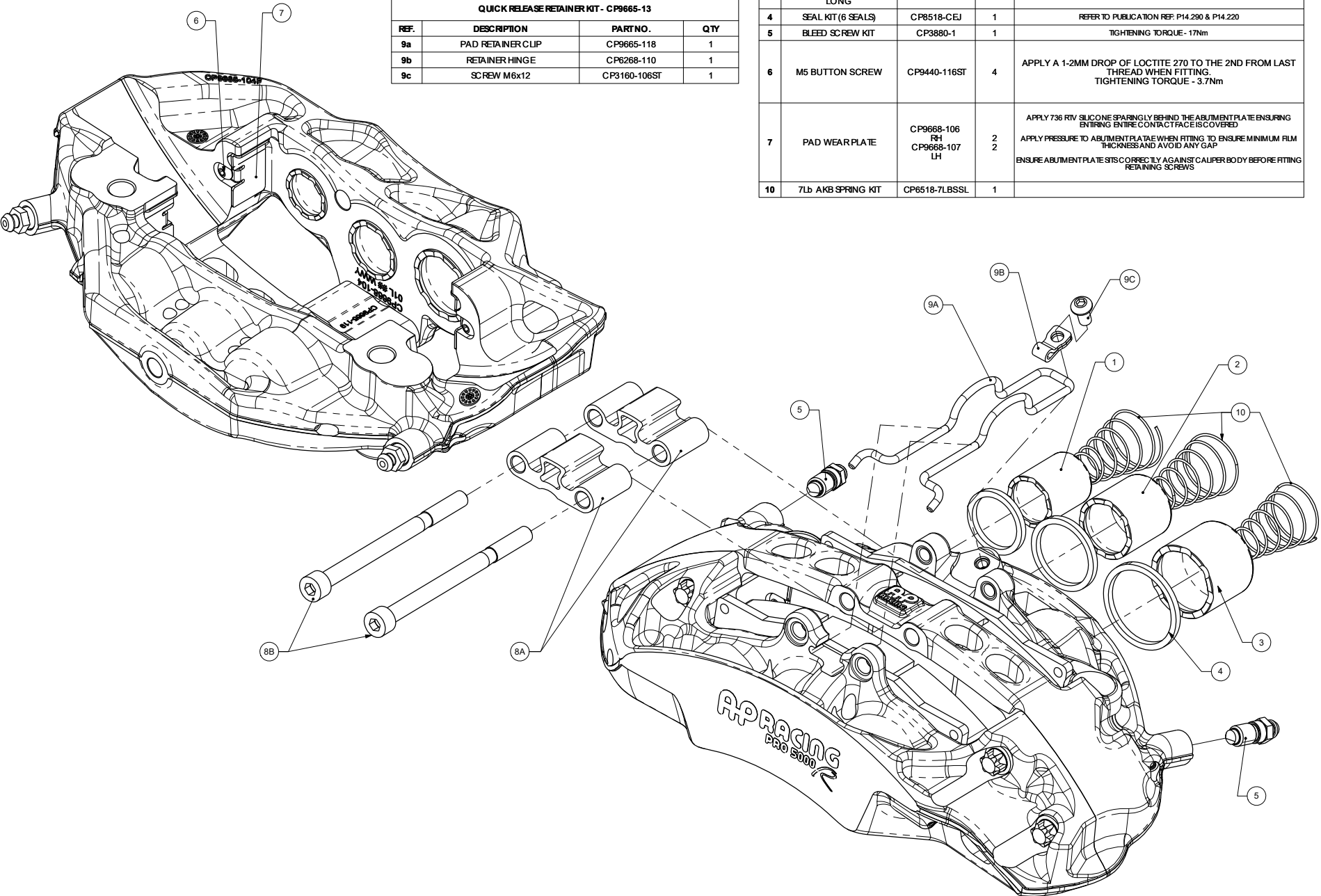

Issue No.	Alterations		Zone	Initials
	Date & No.	Particulars		
		SEE SHEET 1 FOR DETAILS		

SCALE 1:5	SHEET 2 OF 2
DRAWN Jon Tait	
APPROVED	
DERIVED FROM cp9665-1cd	
TITLE 6 PISTON PRO 5000 R CALIPER 180x42 MOUNTING	
DRG NO. CP9668-1CD	